



Sharp's New Projectors with High Brilliance and Multiple Complement of Inputs Supports a Wide Range of Business, School, and Personal Applications



High Brightness Projector with HDMI Terminal

3,000 Lumen High Brightness

Sharp's advanced optoelectronics technology maximizes light output, providing crystal clear images in high brightness of 3,000 lumens.

HDMI Terminals

Digital-to-digital connection can be made simply by using a cable, delivering high-quality reproduction

A Variety of Basic Features

BrilliantColor™ Technology with Six-Segment Color Wheel

BrilliantColor™ technology improves picture brilliance particularly for intermediate colors providing natural, detailed images.

1.2x Optical Zoom for Flexible Installation

With 1.2X optical zoom, the screen can be enlarged about 40% while maintaining the picture quality. Picture projection can be easily adjusted in various situations.

Presentation Assist Remote Control

With the GUI pointer, five different icons can be displayed to effectively use for your presentations. Three spotlight sizes, ranging from 1/25, 1/9 or 1/8 the screen provide visual effects to focus on a specified subject.

3D Ready

Incorporating DLP® Link™ technology, 3D image projections provide a wider range of applications, allowing fuller perception of images for presentations and various content.

Other Outstanding Features

OSD Setup Guide for Intuitive Operation

The projector setup guide provides interactive on-screen images to display the next step for setup. (Focus, zoom and height adjustment)

Quick Menu OSD

The projectors are equipped with on-screen display quick menus to immediately set the resolution, keystone and Eco Mode.

Wall Color Function

This function allows you to project the image to a colored surface or wall* without using a screen.

* Blackboard (dark green), Whiteboard and colored wall (Green, Yellow green, Yellow, Orange, Pink, Purple, Blue, Greenish blue)

Direct Power Off Switching

Direct Power Off lets users immediately unplug the projector and take it from its location. In addition, it also helps control the power simultaneously for multiple projectors by using the room's primary power switch with the auto restart function.

Rear Terminals

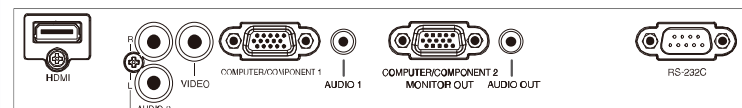

Screen Size and Projection Distance (4:3 Signal Input)

Screen	Picture size			Projection distance [L]		Distance from the lens center to the bottom of the image [H]
	Diag.	Width (cm)	Height (cm)	Minimum [L1]	Maximum [L2]	
300"	240" (610)	180" (457)		389" (11.8m)	465" (14.2m)	6 23/32" (17cm)
200"	160" (406)	120" (305)		2510" (7.9m)	3011" (9.4m)	4 31/64" (11cm)
100"	80" (203)	60" (152)		1211" (3.9m)	156" (4.7m)	2 15/64" (6cm)
40"	32" (81)	24" (61)		52" (1.6m)	62" (1.9m)	5/16" (2cm)

PG-SX80



Dimensions

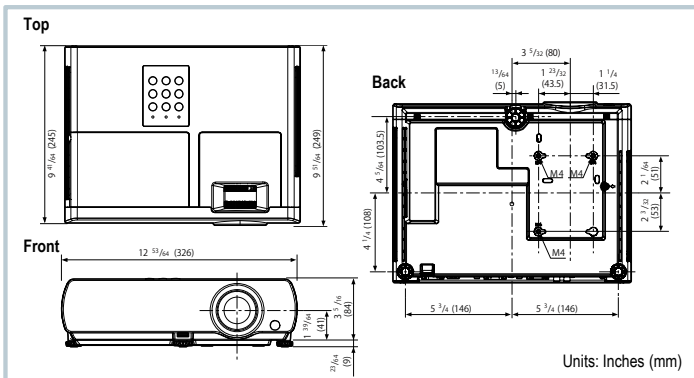

Specifications

Models		PG-SX80
Display devices		0.55" DLP® chip x 1
Resolution		XGA (1,024 x 768)
Brightness		3,000 lumens
Contrast ratio		2,000:1
Lens	F number	F 2.5 to 2.7
	Zoom	Manual, x1.2 (Varifocal Lens)
	Focus	Manual (f = 21.8 to 25.6 mm)
Picture size		40" (102 cm) to 300" (762 cm)
Projection distance		40": 1.6 to 1.9 m, 100": 3.9 to 4.7 m, 300": 11.8 to 14.2m
Input signals	Computer RGB	UXGA*, WSXGA+, SXGA+, SXGA, WXGA+, WXGA, XGA, SVGA, VGA Mac 21", Mac 19", Mac 16", Mac 13" [* Analog only]
	DTV	1080P, 1080i, 1035i, 720P, 576P, 576i, 540P, 480P, 480i
Input terminals	HDMI	x1
	Computer / Component (mini D-sub 15-pin)	x2
	Composite Video (RCA)	x1
	USB (Type A)	-
	Audio (φ 3.5-mm stereo minijack)	x1
	Audio (RCA)	x1 (L/R)
Output terminals	Computer / Component (mini D-sub 15-pin)	1 (Shared with computer / component input 2, switchable)
	Audio (φ 3.5-mm stereo minijack)	1 (variable audio output)
Control terminal	LAN (RJ-45)	-
	RS-232C (D-sub 9-pin)	x1
Horizontal frequency		15 to 110 kHz
Vertical frequency		45 to 85 Hz
Audio system		7W (Mono)
Fan noise	Eco+Quiet off / Eco+Quiet On	35 dB / 28 dB
Projection lamp		230 W
On-screen display Languages		English, German, Spanish, Dutch, French, Italian, Swedish, Portuguese, Russian, Polish, Hungarian, Turkish, Arabic, Persian, Vietnamese, Simplified Chinese, Korean, Japanese
Rated voltage		AC100 to 240 V
Rated frequency		50 / 60 Hz
Input current		3.0 A
Power consumption	Eco+Quiet Off	293W with AC 100V, 287W with AC 240V
	Eco+Quiet On	216W with AC 100V, 216W with AC 240V
Standby mode	Quick Start	2.5W with AC 100V, 2.9W with AC 240V
	Eco	0.33W with AC 100V, 0.57W with AC 240V
Operation temperature		5°C to 35°C
Cabinet		Plastic
Dimensions (main body only) W x H x D		326 x 84 x 245 mm
Weight (approx.)		5.7 lbs. (2.6kg)
Supplied accessories		Remote control, two LR03 (AAA) batteries, power cord (6' (1.8 m)), RGB cable (6' (1.8m)), Initial setup guide, CD-ROM
Optional accessories		Spare lamp : AN-SX80LP

Precautions on Viewing Stereoscopic 3D

- The sense of three-dimensionality may vary between individuals.
- Viewing stereoscopic 3D may cause discomfort or eye strain.
- For protection of proper eye development, children should avoid viewing stereoscopic 3D.
- Avoid viewing stereoscopic 3D if you have a pre-existing oversensitivity to light, sleep disorder, heart disease, or are pregnant, in poor health, feeling unwell, or inebriated.
- Read the operation manual carefully to ensure viewing stereoscopic 3D with safety and comfort.

Design and specifications are current as of September 2013, but are subject to change without notice. • DLP®, the DLP logo are trademarks or registered trademarks of Texas Instruments. • The terms HDMI and HDMI High-Definition Multimedia Interface, and the HDMI logo are trademarks or registered trademarks of HDMI Licensing, LLC, in the United States and other countries. • PJLink is a registered trademark or an application trademark in Japan, the United States, Canada, the E.U., China and other countries or regions. • All company and product names are trademarks or registered trademarks of their respective manufacturers. Sharp makes no warranties or representations of any kind with respect to these products. • Brightness values indicate overall average values of the product at the time of shipment and are stated based on ISO21118-2005.

SHARP

SHARP CORPORATION OSAKA, JAPAN

© SHARP CORP.